

Adding Coral to a Saltwater Aquarium

What you will need

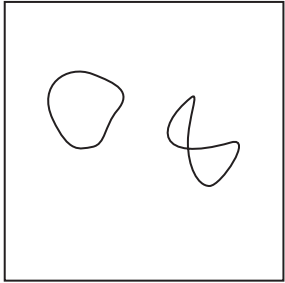

2 Rubber bands.

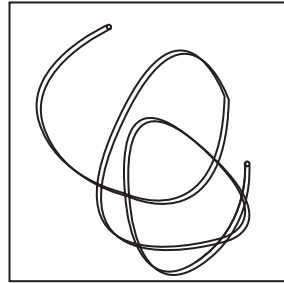

6 Feet of 1/4 inch air tubing.

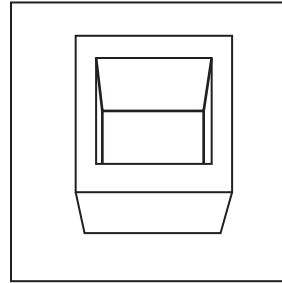

A medium-sized 1 gallon food-grade plastic container.

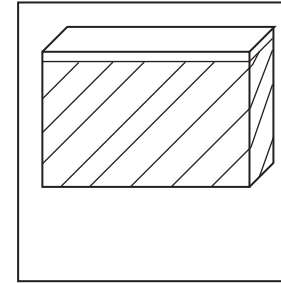

A saltwater aquarium.

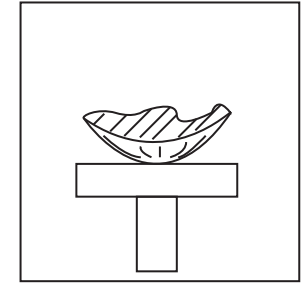

A piece of coral.

Getting the coral to your aquarium

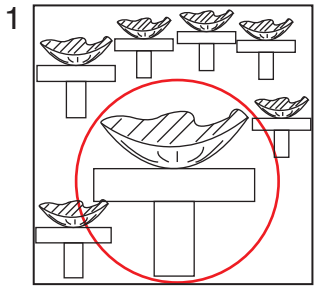

1 Pick out a coral that you want from a local fish store.

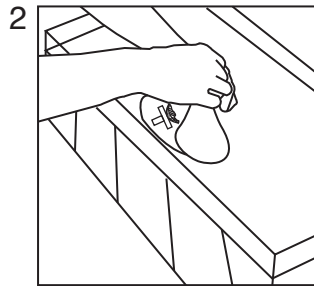

2 Place the coral in a bag and fill the bag 1/2 way with water from the aquarium that the coral was in.

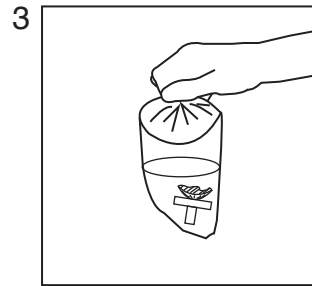

3 Fill the rest of the bag with air and tie the bag off with a rubber band.

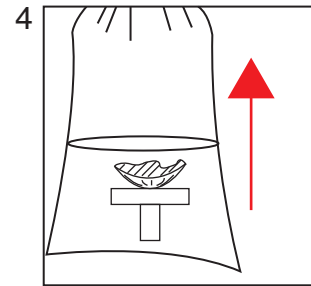

4 While taking the coral back to your tank, make sure to keep the bag upright.

Setting up

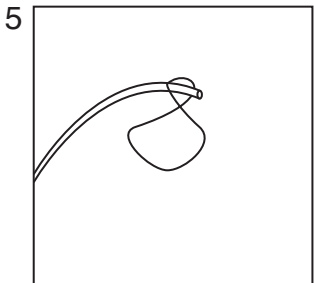

5 Place one end of the air tubing through one of the rubber bands.

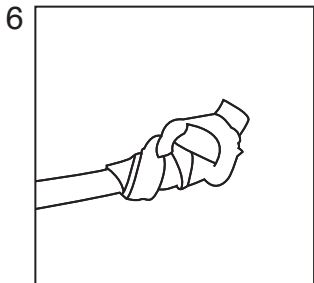

6 Twist both of the rubber bands around the air tube until it is completely wrapped around.

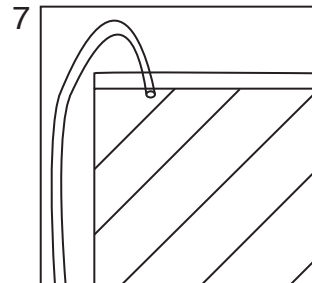

7 Place the end of the tube without the rubber bands into your aquarium.

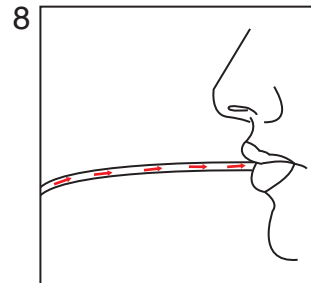

8 Suck on the end of the tube with the rubber bands to create a siphon.

Acclimating the coral

9

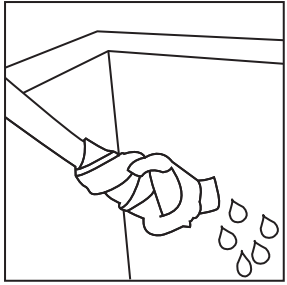

Put the banded side of the tube into the container. Flow should ~ 2 drops/second.

10

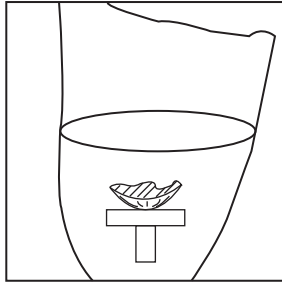

Open the bag that the coral is in.

12

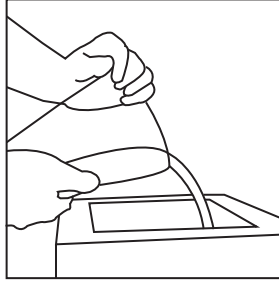

Pour the water into the small container and gently drop the coral into the water.

13

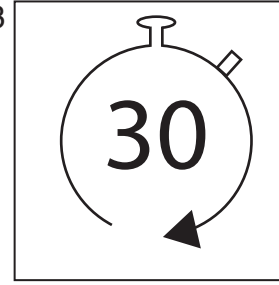

Wait for thirty minutes.

14

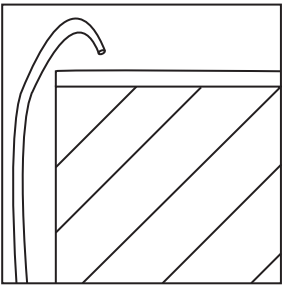

Remove the end of the air tube that is in your aquarium.

15

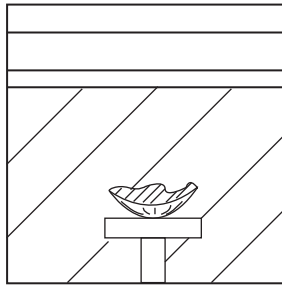

Place the coral into your aquarium.